



Sealgauge® Diaphragm Gauges

High Overpressure Safety

316SS Wetted Parts

Process Industry Series • Standard Case • Type 43X.56

Pressure Gauges

Application

Where low system pressure alternates with high pressure cycles. All stainless steel pressure gauge. Suitable for corrosive environments and gaseous and liquid media. With optional flanged connection and available for viscous and contaminated media.

Sizes (All sizes not stocked)

4" and 6" (100 and 160 mm)

Accuracy

± 1.5% of span

Ranges

Vacuum / Compound to 30"HG / 0 / 200 PSI
Pressure from 10" H₂O to 100" H₂O (6" flange diameter)
Pressure from 6 PSI to 600 PSI (4" flange diameter)
or other equivalent units of pressure or vacuum

Working Range

Steady: full scale value
Fluctuating: 0.9 x full scale value

Overpressure Safety

Choice of 600, 1500, or 6000 PSI

Operating Temperature

Ambient: -4°F (-20°C) to 140°F (60°C)
Media: max. + 212°F (+100°C)

Temperature error

Additional error when temperature changes from reference temperature of 68°F (20°C) ± 0.3% for every 18°F (10°C) rising or falling. Percentage of span.

Standard Features

Connection (exposed to pressure medium)

Material: 316 stainless steel
1/2" NPT

Diaphragm Housing

Upper: Chrome-steel
Lower: 316 stainless steel

Diaphragm Element

316 stainless steel for ranges ≤ 100" H₂O
Duratherm (NiCrCo-alloy) for ranges ≥ 200" H₂O

Diaphragm Gasket

FPM (Viton)

Movement

Stainless steel

Dial

White aluminum with black lettering

Pointer

Black aluminum

Case

Stainless steel case with pressure vent in back of case and stainless steel bayonet ring.



Weather Protection

Weather resistant (NEMA 3 / IP 54)
Weather tight (NEMA 4X / IP 65) liquid filled case

Window

Laminated safety glass

Order Options

Glycerine, silicone, and fluorolube case filling (**Type 433.56**)
Vacuum safe to 30"Hg
Extended media temperature up to 392°F
Pressure connection with DIN or ANSI flange

Alarm contacts (see data sheet AAE 08.01)

Transmitters (see data sheet AE 08.02)

APM 43X.56

(APM 04.07)

Dimensions:

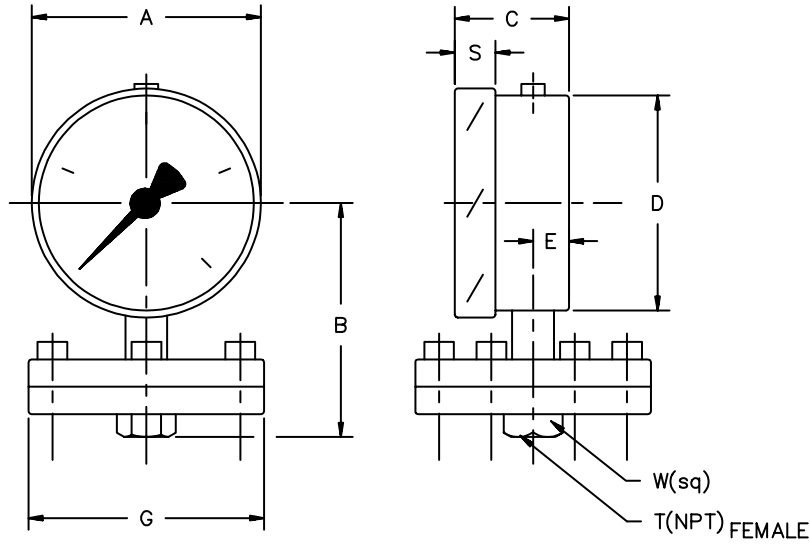

A* NOMINAL SIZE

TYPE	WEIGHT	OVERPRESSURE SAFETY	KEY	A*	B	C	D	E	G	S	T	W
432.56 4"	3.8 lbs.	600 OR 1500 PSI	mm	100	104	49.5	99	15.5	100	17.5	--	27
			in	4	4.09	1.95	3.90	0.61	3.94	0.69	1/2"	1.06
432.56 6"	4.9 lbs.	600 OR 1500 PSI	mm	160	134	49.5	159	15.5	100	17.5	--	27
			in	6	5.28	1.95	6.26	0.61	3.94	0.69	1/2"	1.06

NOTE: For ranges 100" H2O PSI and lower, G dimension changes to 160 mm (6") and weight increases by approx. 4 lbs.
For ranges 100" H2O PSI and lower, G dimension changes to 190 mm (7.48") and weight increases by approx. 20 lbs.

THE MEASURE OF
Total Performance™

Ordering Information:

State computer part number (if available) / type number / size / range / connection size and location / options required.

Specifications given in this price list represent the state of engineering at the time of printing. Modifications may take place and the specified materials may change without prior notice

05/01



WIKAI Instrument Corporation
1000 Wiegand Boulevard
Lawrenceville, Georgia 30043-5868
Tel: 770-513-8200 Fax: 770-338-5118
<http://www.wika.com> e-mail: info@wika.com